

At Salsa, we believe that a sense of adventure makes life better. The bicycle can be so much more than just a bike; it's a path to new places, new people, and amazing experiences.

Thank you for your purchase. We hope it makes a good riding experience even better!

Salsa. Adventure by bike.

**▲ WARNING:** CYCLING CAN BE DANGEROUS. BICYCLE PRODUCTS SHOULD BE INSTALLED AND SERVICED BY A PROFESSIONAL MECHANIC. NEVER MODIFY YOUR BICYCLE OR ACCESSORIES. READ AND FOLLOW ALL PRODUCT INSTRUCTIONS AND WARNINGS INCLUDING INFORMATION ON THE MANUFACTURER'S WEBSITE. INSPECT YOUR BICYCLE BEFORE EVERY RIDE. ALWAYS WEAR A HELMET.

## Intended Use

The Salsa Split Pivot® Dropout Tool Top Cap is a 22mm socket designed for in-the-field derailleur hanger replacement of Salsa suspension frames featuring Split Pivot technology. The Dropout Tool is designed to double as a top cap for a standard threadless stem/headset assembly, so that it will always be conveniently available in the event of a hanger failure. This tool is intended for trailside repairs only. Once you return back to base, use a torque wrench to achieve the proper torque spec of 18Nm.

## Compatibility

The Split Pivot Dropout Tool is compatible with the axle nuts found at the rear dropout/pivot on all Salsa Split Pivot models. It is designed to be used in conjunction with a 6mm hex key, commonly found on bicycle mini-tools, etc. The Dropout Tool's unique design also allows it to also function as a top cap and fit most 1-1/8" threadless stem and steerer tube assemblies. **NOTE:** The Split Pivot Dropout Tool has a slightly deeper draft than a standard top cap. If/when installing the Split Pivot Dropout Tool as a top cap check to make sure there is adequate clearance (2mm) between it and the star nut or compression plug in the fork. Additional headset spacers may be required.

## Tools:

- 5mm Hex Wrench
- 6mm Hex Wrench

## Instructions

### To install as a top cap (fig. 1):

1. Before beginning check to make sure the headset and stem are properly installed, pre-loaded, and adjusted. Refer to stem and headset manufacturer instructions if necessary.
2. Using a 5mm wrench, remove the top cap preload bolt and existing top cap from the bicycle (loosening the stem clamping bolt is not necessary).
3. Check the fit of the Split Pivot Dropout Tool—ensure there is at least a 2mm gap between the tool and the star nut or compression plug (fig. 1).

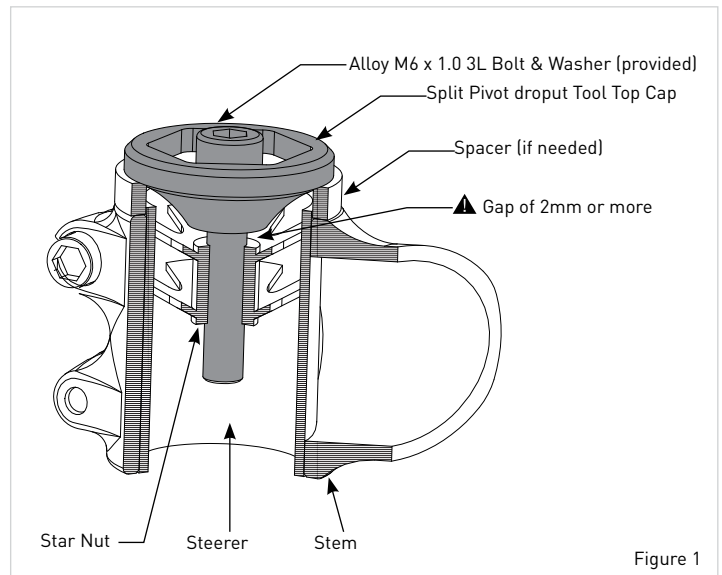

4. If clearance is adequate, lightly grease the included fixing bolt, and secure the Dropout Tool to the stem/headset assembly via the star nut or compression plug.
5. If clearance is not adequate, complete Steps 6 and 8.
6. Determine how many additional spacer(s) are needed to achieve proper clearance between the Dropout Tool and the star nut/compression plug. This may require modifying the spacer and stem arrangement to achieve proper stem engagement, which will require loosening the stem (refer to fork/stem manufacturer instructions).
7. Once the additional spacer arrangement has been sorted and proper clearance has been achieved, lightly grease the included fixing bolt, and preload the headset to the headset manufacturer specification and finish by torquing the stem clamping bolts to the stem makers' specification.

### Using the Split Pivot Dropout Tool to change a damaged derailleur hanger in the field (fig. 2):

1. Locate a suitable location off the trail in a safe place to work on your bike.
2. Using a 5mm hex wrench, free the Split Pivot Dropout Tool from the stem/steerer by removing the fixing bolt. Put the Dropout Tool and fixing bolt in a safe location (like your pocket).
3. Flip the bike over so it is resting upside down on the handlebars and seat.
4. Remove the rear axle and rear wheel from the bicycle.
5. With the appropriate tool (5mm hex key, T25, etc.) remove the derailleur from the damaged hanger.
6. Place the Split Pivot Dropout Tool on the drive side axle nut.
7. Insert a 6mm hex wrench fully through the center broach of the Dropout Tool and turn in a counter-clockwise direction to remove the axle nut from the axle stud.

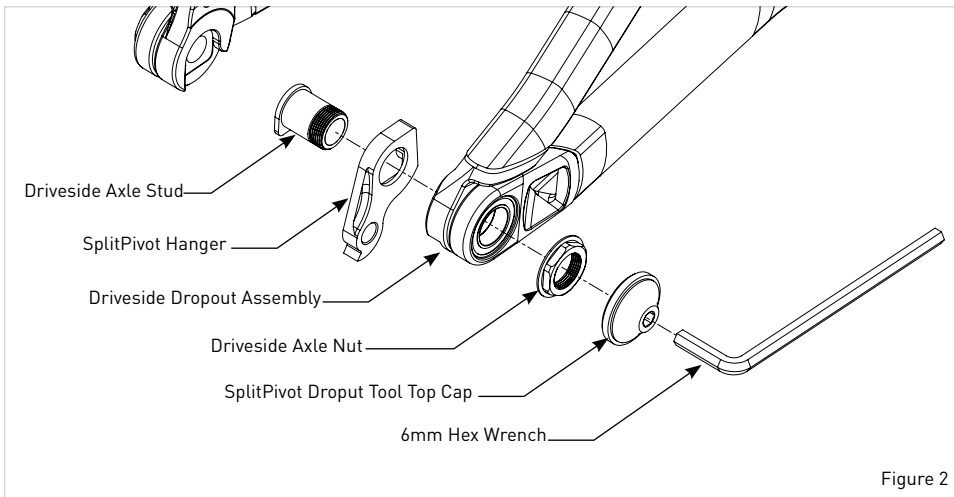

Figure 2

## Three-Year Warranty

All Salsa bicycle forks, parts and components: This warranty applies to 2014 and newer model bicycles and covers only Salsa Cycles branded product. Any other original part or component shall be covered by the stated warranty of the original manufacturer. Any products not specifically included above are hereby omitted.

TO THE EXTENT NOT PROHIBITED BY LAW, THESE WARRANTIES ARE EXCLUSIVE AND THERE ARE NO OTHER EXPRESS OR IMPLIED WARRANTIES OR CONDITIONS INCLUDING MERCHANTABILITY AND FITNESS FOR A PARTICULAR PURPOSE.

This warranty does not cover the following:

- Damage due to improper assembly or follow-up maintenance or lack of skill, competence, or experience of the user or assembler
- Products that have been modified, neglected, used in competition or for commercial purposes, misused or abused, involved in accidents or anything other than normal use
- Installation of components, parts, or accessories not originally intended for use with or compatible with Salsa product
- Damage or deterioration to the surface finish, aesthetics or appearance of the product including but not limited to paint damage
- Normal wear and tear
- Labor required to remove and/or refit and re-adjust the product within the Salsa product
- Damage to carbon fiber caused by any carbon assembly paste

This limited warranty is expressly limited to the repair or replacement of a defective product, at the option of Salsa Cycles, and is the sole remedy of the warranty. This limited warranty applies only to the original purchaser of the Salsa Cycles product and is not transferable. This warranty applies only to Salsa Cycles products purchased through an authorized dealer or distributor.

In no event shall Salsa Cycles be liable for any loss, inconvenience or damage, whether direct, incidental, consequential, or otherwise resulting from breach of any express or implied warranty or condition, of merchantability, fitness for a particular purpose, or otherwise with respect to our products except as set forth herein. This warranty gives the consumer specific legal rights, and those rights and other rights may vary from place to place. This warranty does not affect your statutory rights.

## Warranty Registration:

Proof of purchase is required before a warranty claim is processed. Salsa Cycles therefore strongly encourages warranty registration at [salsacycles.com](http://salsacycles.com). Failure to register will not affect consumer rights under the limited warranty stated above, so long as the consumer can show in a reasonable manner proof of original ownership and the date the Salsa Cycles product was purchased.

If you have any questions contact [warranty@salsacycles.com](mailto:warranty@salsacycles.com)

8. Push the driveside axle stud and hanger out of the dropout assembly (towards the frame center).
9. Slide the damaged hanger off the axle stud, and replace it with your good, spare hanger (you always carry a spare hanger, right?!!)
10. Re-insert axle stud/hanger assembly through the dropout assembly and carefully re-thread the axle nut onto the stud.
11. Once the axle nut has been pre-threaded, use the Dropout Tool and 6mm hex wrench to firmly tighten the axle nut down.
12. Re-install the derailleur on the hanger, then the rear wheel and axle.
13. Flip the bike back over and secure the Split Pivot Dropout Tool back on the stem/fork assembly.
14. Take a couple minutes to check and adjust the rear derailleur for proper shifting, look for anything else that may have been damaged.

**NOTE:** The Split Pivot Dropout Tool is only intended for emergency trailside maintenance. Once back to civilization, remove and reinstall the driveside axle nut using blue thread locking compound and torque to 17–18Nm.

## Ongoing Maintenance

Periodically check that the 5mm hex bolt in the center of the Split Pivot Dropout Tool is adequately snug.

## Salsa Cycles Limited Warranty

All Salsa products are warranted against manufacturing defects in materials and workmanship from the date of retail purchase of the product, subject to the limitations detailed below. Save your dated receipt for proof of purchase.

## SALSA CYCLES

6400 West 105th Street, Bloomington, MN 55438  
Tel: 877-MOTO-ACE Fax: 952-983-6210  
[www.salsacycles.com](http://www.salsacycles.com)