



SUSPENSION FRAME SERVICE - FLIP CHIP SHOCK MOUNT HARDWARE

At Salsa, we believe that a sense of adventure makes life better. The bicycle can be so much more than just a bike; it's a path to new places, new people, and amazing experiences.

Thank you for your purchase. We hope it makes a good riding experience even better!

Salsa. Adventure by bike.®

▲ WARNING: Cycling can be dangerous. Bicycle products should be installed and serviced by a professional mechanic. Never modify your bicycle or accessories. Read and follow all product instructions and warnings including information on the manufacturer's website. Inspect your bicycle before every ride. Always wear a helmet.

Compatibility & Intended Use

These instructions cover service and replacement of the flip chips and hardware located at the rear end of the shock where it connects to the shock link.

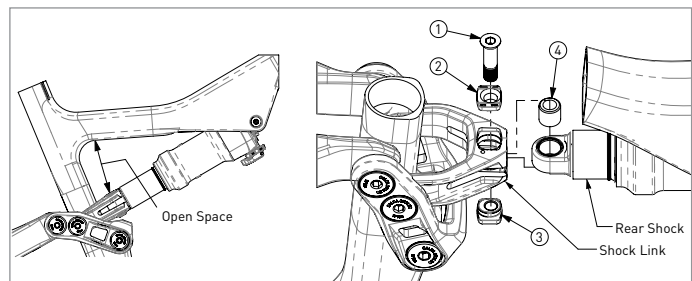
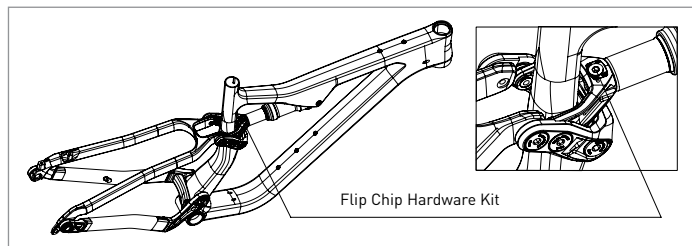

Flip chip / rear shock-to-shock link connection for Horsethief & Spearfish Carbon. (Orient chips & bolt to enter from top side.)

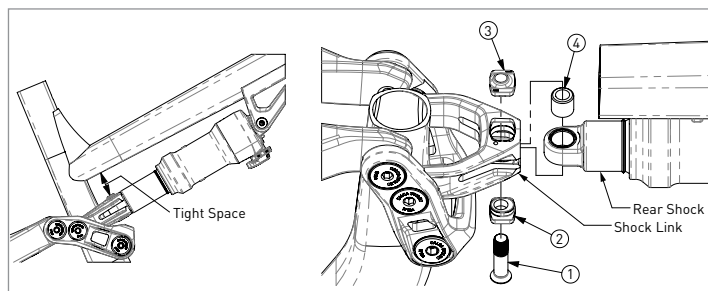

Flip chip / rear shock-to-shock link connection for Rustler Carbon and Rustler, Horsethief, & Spearfish aluminum models. (Orient chips & bolt to enter from bottom side.)

Required Hardware

Hardware kits required to service this area include:

- 1593 Flip Chip Hardware Kit which is compatible with:
 - MY19+ Spearfish Aluminum (all spec levels)
 - MY19+ Horsethief Aluminum (all spec levels)
 - MY19+ Rustler Aluminum (all spec levels)
- 1215 Shock Eyelet Reducer which is compatible with:
 - MY19+ Spearfish Carbon (all spec levels)
 - MY19+ Horsethief Carbon (all spec levels)
 - MY19+ Rustler Carbon (all spec levels)

Required Tools & Supplies

- Torque wrench
- 5mm hex bit
- Lightweight grease
- Loctite Blue 242®

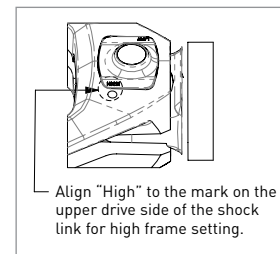
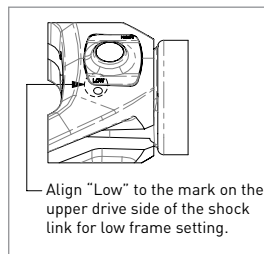
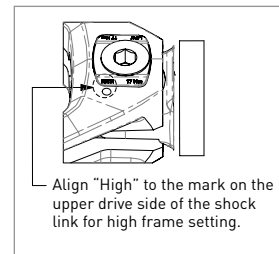
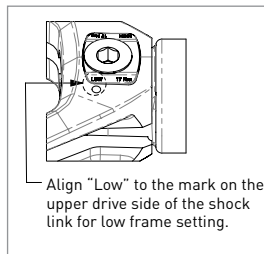

Item #	Description	Item Notes	Found in Kit #	Qty.	Applies to	Tools	Prep	Torque
1	1224 Flathead Pin	M8 x 1.0, 30.5mm total length	1593	1		5mm hex bit	--	17Nm (150 in-lbs)
2	1218 Flip Chip	Counter sunk, thru hole	1593	1	MY19+ Spearfish Aluminum MY19+ Horsethief Aluminum MY19+ Rustler Aluminum	--	Lightly grease counter sink for bolt head	--
3	1219 Flip Chip	M8 x 1.0	1593	1		--	Loctite Blue 242® on threads	--
4	1215 Eyelet Reducer	∅8 x ∅12.7 x 12.5mm long	1215	1	MY19+ Spearfish Carbon MY19+ Horsethief Carbon MY19+ Rustler Carbon	Arbor press/ eyelet tool	Clean shock bushing	--



SUSPENSION FRAME SERVICE - FLIP CHIP SHOCK MOUNT HARDWARE

Service Notes

(Refer to the images and table on page 1, and notes below for proper installation.)

Flip Chip Recommended Settings

Determine flip chip setting preference.

Consider using "Low" when:

- Additional cornering stability is desired and pedal strikes are not an issue
- A 130mm or 140mm fork is installed with 29 x 2.4–2.6" tires (Spearfish and Horsethief)
- A 150mm fork is installed with 27.5 x 2.5–2.8" tires (Rustler)

Consider using "High" when:

- More ground clearance or reducing the chance of pedal strikes is desired
- A 120mm fork is installed (Spearfish and Horsethief)
- A 130–140mm fork is installed (Rustler)
- Tires smaller than 29 x 2.4" are used (Spearfish and Horsethief)
- Tires smaller than 27.5 x 2.5" are used (Rustler)
- The frame is retro-fitted with 27.5 plus wheels and tires (Spearfish and Horsethief)

Flip Chip & Bolt Adjustment or Service Notes

For Rustler, Rustler Carbon, Horsethief, and Spearfish

Aluminum models:

- Remove pressure from the rear shock and compress the suspension at least half way. This will provide adequate space to access, remove, and install the bolt and chips
- Orient the flip chips and bolt to install from the bottom side of the link. This will provide adequate space for tool access to the bolt head

For Horsethief and Spearfish models:

- There is adequate space under the top tube to orient the chips and bolt to install from the top side. Air does not need to be removed from the shock

All models:

- Apply a thin coat of grease to just the underside of the bolt head and counter sunk hole of the flip chip for smooth and accurate torquing. Keep the shock's eyelet tab and link clean and dry to prevent slip, which can lead to creaking
- Apply a small amount of thread-locking agent (Loctite Blue 242®) to the threaded flip chip. Try to avoid getting the thread-locking compound on the bolt shank or lower chip faces as this can make removal difficult after it has cured
- Torque to spec and let cure for 24 hours. This will ensure the bolt will remain tight and keep adequate clamping force between the link and shock

Eyelet-Reducing Hardware Service Notes

- Remove and isolate the rear shock from the rest of the frame before removing or installing eyelet-reducing hardware

- Refer to shock manufacturer's instructions for proper bushing and eyelet-reducing hardware service, use the 1215 Eyelet Reducer provided by Salsa
- Refer to the Shock Mount Hardware instructions for servicing hardware at the front end of the rear shock

Service Intervals & Ongoing Maintenance

- Inspect pivot hardware for wear or damage at least annually. If pivot hardware becomes damaged, stripped, or develops play that cannot be eliminated with the proper torque specification, replace the affected part(s)
- Inspect the shock eyelet-reducing hardware and eyelet bushing for damage or wear at least annually. If play develops between the shock bushing, shock pin, or frame that cannot be eliminated with proper torque, replace the affected part(s)
- Check pivot hardware for proper torque every 50 riding hours. Reapply thread lock compound and re-torque as needed

Warranty

Salsa Cycles warrants this new Salsa product against defects in materials and workmanship for two (2) years from the original date of retail purchase by the consumer. This limited warranty is expressly limited to the repair or replacement of the original product, at the option of Salsa Cycles, and is the sole remedy of the warranty. This limited warranty applies only to the original purchaser of the Salsa product and is not transferable. In no event shall Salsa Cycles be liable for any loss, inconvenience or damage, whether direct, incidental or consequential or otherwise resulting from breach of any express or implied warranty or condition, of merchantability, fitness for a particular purpose, or otherwise with respect to this product except as set forth herein.

This warranty does not cover the following:

- Damage due to improper assembly or follow-up maintenance or lack of skill, competence or experience of the end user
- Products that have been modified, neglected, used in competition or for commercial purposes, misused or abused, involved in accidents or anything other than normal use
- Damage or deterioration to the surface finish, aesthetics or appearance of the product
- Normal wear and tear
- Labor required to remove and/or refit and re-adjust the product within the bicycle assembly

To the extent not prohibited by law, these warranties are exclusive and there are no other express or implied warranties or conditions including warranties or conditions of merchantability and fitness for a particular purpose.

Proof of purchase is required before a warranty claim is processed. Salsa Cycles therefore strongly encourages warranty registration at salsacycles.com. Failure to register will not affect consumer rights under the limited warranty stated above, so long as the consumer can show in a reasonable manner proof of original ownership and the date the Salsa Cycles product was purchased.

If you have any questions contact warranty@salsacycles.com or visit www.salsacycles.com/support for more warranty information.

SALSA CYCLES

6400 West 105th Street, Bloomington, MN 55438

Tel: 877-668-6223 Fax: 952-983-6210

www.salsacycles.com