

At Salsa, we believe that a sense of adventure makes life better. The bicycle can be so much more than just a bike; it's a path to new places, new people, and amazing experiences.

Thank you for your purchase. We hope it makes a good riding experience even better!

Salsa. Adventure by bike®.

⚠ WARNING: Cycling can be dangerous. Bicycle products should be installed and serviced by a professional mechanic. Never modify your bicycle or accessories. Read and follow all product instructions and warnings including information on the manufacturer's website. Inspect your bicycle before every ride. Always wear a helmet.

Intended Use

The Salsa Full Sus Framepack is intended for ASTM 3 conditions shown below. The Full Sus Framepack carries gear and clothing within your frame's front triangle, keeping weight centered and out of the way of off-road obstacles.



Intended for ASTM 3 conditions, defined as rough trails, rough unpaved roads, rough terrain, and unimproved trails that require technical skills. Jumps and drops should not exceed 24" (61 cm).

They are NOT INTENDED for hardcore freeriding, extreme downhill, dirt jumping, slopestyle, or very aggressive or extreme riding.

Compatibility

Each size of the Full Sus Framepack is designed for optimal fit with the corresponding frame size. See salsacycles.com/safety for bag and frame compatibility

⚠ WARNING: Check with your bicycle's manufacturer to verify bicycle cargo load capacity. Do not exceed the bicycle manufacturer permissible load.

⚠ WARNING: Bicycles and components do not last forever. See warranty for coverage terms and claims process.

Recommended Materials

2"-wide roll heavy-duty carton sealing tape—clear

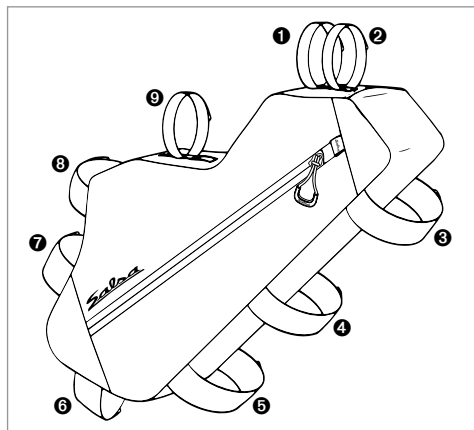

Figure 1

Installation Instructions

1. Remove water bottle cages from your frame. If you are leaving water bottle cage bolts in the frame, place button head bolts into the existing bolts to minimize contact abrasion and wear to the framepack.

NOTE: Vibration from normal riding and road grit can cause paint abrasion wear under the attachment straps. To reduce the possibility of paint damage, wrap at least one layer of 2" clear heavy-duty carton sealing tape around the frame under each attachment strap. Keep the frame clean and remove road grit to help prevent wear. Damage to the bicycle frame from the framepack or protective method is not covered by Salsa Cycles warranty.

2. Open the hook-and-loop attachment straps and place the framepack inside the main triangle of the frame.
3. Fasten hook and loop straps 1 & 2 (fig. 1) at the toptube first. Then work in a clockwise direction and join straps 3–8 to the frame.
4. Finish by securing strap 9 to the shock.
5. Make adjustments to ensure an optimal fit.

⚠ WARNING: Dangling straps, cables or cords risk getting caught in the wheel. Be sure to secure all straps, cables, and cords before riding. Make sure that the bag and straps do not interfere with the function of your bicycle BEFORE attempting to ride. Ensure cargo is distributed evenly.
6. Install a hydration bladder, portable power pack, or electronics in the framepack and route the tube and cables out the bottom port. Secure the tube and cables to the frame to prevent entanglement with the crank, chain, derailleur, driveside pedal, and front wheel.

⚠ WARNING: Prior to storing any power packs or battery-powered electronic devices in your frame bag review each devices owner's manual. Some devices may have temperature, airflow and humidity storage requirements. Failure to follow your electronic devices storage instructions could result in damage to your device, frame bag, and even start a fire.



SALSA EXP SERIES FULL SUS FRAMEPACK INSTRUCTIONS

Ongoing Maintenance

ZIPPER CAUTIONS

Ensure the zipper lies flat over your cargo before closing. Forcing the zipper over a bulged-out/overpacked area can cause the zipper teeth to separate and result in irreparable damage to the framepack.

If the zipper does not close easily, check for fabric or threads caught in the teeth or slider mechanism. Remove any debris that causes binding.

NOTE: Damage caused by excessive force may not be covered by the warranty.

ZIPPER CARE

Cleaning: Remove road grit and dirt regularly to ensure smooth zipper operation. To clean, close the zipper with the slider all the way to the top. Then wipe brush off dirt and grit.

Lubrication: Apply paraffin or ZIPPYCOOL® to the front and back side of the zipper teeth to reduce opening/closing force. Work the slider up and down several times to distribute the lubricant.

FABRIC CARE

Hand wash with warm water and all-purpose detergent. Air dry.

Warranty

Proof of purchase is required before a warranty claim is processed. Salsa Cycles therefore strongly encourages warranty registration at salsacycles.com. Failure to register will not affect consumer rights under the limited warranty stated above, so long as the consumer can show in a reasonable manner proof of original ownership and the date the Salsa Cycles product was purchased. If you have any questions contact warranty@salsacycles.com

SALSA CYCLES

6400 West 105th Street, Bloomington, MN 55438
Tel: 877-MOTO-ACE Fax: 952-983-6210
www.salsacycles.com