

# COLOSSAL/VAYA FENDER INSTRUCTIONS

At Salsa, we believe that a sense of adventure makes life better. The bicycle can be so much more than just a bike; it's a path to new places, new people, and amazing experiences.

Thank you for your purchase. We hope it makes a good riding experience even better! !

Salsa. Adventure by bike.

**▲ WARNING: CYCLING CAN BE DANGEROUS. BICYCLE PRODUCTS SHOULD BE INSTALLED AND SERVICED BY A PROFESSIONAL MECHANIC. NEVER MODIFY YOUR BICYCLE OR ACCESSORIES. READ AND FOLLOW ALL PRODUCT INSTRUCTIONS AND WARNINGS INCLUDING INFORMATION ON THE MANUFACTURER'S WEBSITE. INSPECT YOUR BICYCLE BEFORE EVERY RIDE. ALWAYS WEAR A HELMET.**

## Compatibility and Intended Use

Salsa's Fender Mounts are compatible with the Colossal Ti and steel frames, and the Colossal and Vaya carbon forks. They provide a non-permanent fender mounting solution for wet weather riding.

## Intended Use: Condition 3

CONDITION	DESCRIPTION	SALSA MODELS
<p>1 For riding on a paved surface where the tires do not lose ground contact</p>	This is a set of conditions for the operation of a bicycle on a regular paved surface where the tires are intended to maintain ground contact.	
<p>2 For off-road riding and jumps less than 61cm (24")</p>	This is a set of conditions for the operation of a bicycle that includes Condition 1 as well as unpaved and gravel roads and trails with moderate grades. In this set of conditions, contact with irregular terrain and loss of tire contact with the ground may occur. Drops are intended to be limited to 15cm (6") or less.	All Racks Casseroll Fork Colossal Fork Cowbell Handlebars LaCruz Canti Fork LaCruz Disc Fork Vaya Fork Warbird Fork
<p>3 For rough off-road riding and jumps less than 24" (61cm)</p>	This is a set of conditions for operation of a bicycle that includes Condition 1 and Condition 2 as well as rough trails, rough unpaved roads, and rough terrain and unimproved trails that require technical skills. Jumps and drops are intended to be less than 61cm (24").	Bearpaw Fork Cromoto 26" Fork Cromoto 26" Disc Fork Cromoto Grande 29er Fork Enabler Fork Firestarter Forks Makwa Carbon Fork Woodchipper Handlebars
<p>4 For extreme off-road riding</p>	This is a set of conditions for operation of a bicycle that includes Conditions 1, 2, 3, and 4; downhill grades on rough trails at speeds less than 40 km/h (25 mph), or both. Jumps are intended to be less than 122cm (48").	Bend Handlebars Rustler Handlebars Salt Flat Handlebars
<p>5 For dirt jumping</p>	This is a set of conditions for operation of a bicycle that includes Conditions 1, 2, 3, and 4; extreme jumping; or downhill grades on rough trails at speeds in excess of 40 km/h (25 mph); or a combination thereof.	

## Tools:

8mm box end wrench

Torque wrench that measures in Nm

Blue threadlocker

## Fork Installation

1. Remove set screws from fender mounting holes.
2. Apply Blue threadlocker onto fender mount.
3. Thread M5 nuts onto fender mounts.
4. Make sure the nuts are threaded onto the fender mounts at least 6 to 7 threads.
5. Thread fender mounts into fork leg fender-mounting holes.
6. Make sure fender mounts are threaded in at least 4 threads.
7. Thread nut up to the fork leg.
8. Make sure fender mount face is parallel with plane of frame and fork.
9. Tighten nut to 3–4Nm to lock fender mount into position.
10. Check assembly that it is properly tight.
11. Install fenders per fender manufacturer's specifications. (NOTE: Salsa recommends QR fenders only!)
12. An M5 screw will need to be used to mount fender crown hardware to fork.
13. Follow same instructions for rear fender mounting.

## Ongoing Maintenance

Periodically check to make sure all mounting bolts are properly tightened to the frame, and that the fenders are properly installed per the fender manufacturer's specifications.

**▲ WARNING:** Do not mount racks or any other load bearing accessory to the fender mounts. Doing so could result in fork breakage, causing a loss of control. If you are not sure if a device is compatible, consult your dealer.

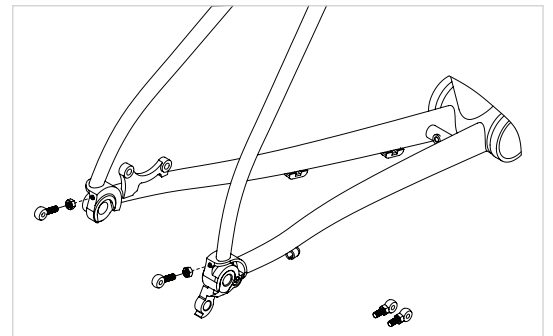
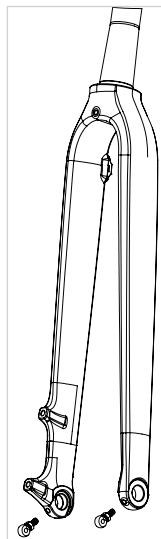



## COLOSSAL/VAYA FENDER INSTRUCTIONS

### Salsa Cycles Limited Warranty

All Salsa products are warranted against manufacturing defects in materials and workmanship from the date of retail purchase of the product, subject to the limitations detailed below. Save your dated receipt for proof of purchase.

### Three-Year Warranty

All Salsa bicycle forks, parts and components:

This warranty applies to 2014 and newer model bicycles and covers only Salsa Cycles branded product. Any other original part or component shall be covered by the stated warranty of the original manufacturer. Any products not specifically included above are hereby omitted.

TO THE EXTENT NOT PROHIBITED BY LAW, THESE WARRANTIES ARE EXCLUSIVE AND THERE ARE NO OTHER EXPRESS OR IMPLIED WARRANTIES OR CONDITIONS INCLUDING WARRANTIES OR CONDITIONS OF MERCHANTABILITY AND FITNESS FOR A PARTICULAR PURPOSE.

For 2013 and older model bicycles and products, please consult your Owner's Manual or contact Salsa Cycles or your Salsa dealer for the applicable warranty information.

This warranty does not cover the following:

- Damage due to improper assembly or follow-up maintenance or lack of skill, competence, or experience of the user or assembler
- Products that have been modified, neglected, used in competition or for commercial purposes, misused or abused, involved in accidents or anything other than normal use
- Installation of components, parts, or accessories not originally intended for use with or compatible with Salsa product
- Damage or deterioration to the surface finish, aesthetics or appearance of the product including but not limited to paint damage
- Normal wear and tear
- Labor required to remove and/or refit and re-adjust the product within the Salsa product
- Damage to carbon fiber caused by any carbon assembly paste

This limited warranty is expressly limited to the repair or replacement of a defective product, at the option of Salsa Cycles, and is the sole remedy of the warranty. This limited warranty applies only to the original purchaser of the Salsa Cycles product and is not transferable. This warranty applies only to Salsa Cycles products purchased through an authorized dealer or distributor.

In no event shall Salsa Cycles be liable for any loss, inconvenience or damage, whether direct, incidental, consequential, or otherwise resulting from breach of any express or implied warranty or condition, of merchantability, fitness for a particular purpose, or otherwise with respect to our products except as set forth herein. This warranty gives the consumer specific legal rights, and those rights and other rights may vary from place to place. This warranty does not affect your statutory rights.

### Warranty Registration:

Proof of purchase is required before a warranty claim is processed. Salsa Cycles therefore strongly encourages warranty registration at [salsacycles.com](http://salsacycles.com). Failure to register will not affect consumer rights under the limited warranty stated above, so long as the consumer can show in a reasonable manner proof of original ownership and the date the Salsa Cycles product was purchased.

If you have any questions contact [warranty@salsacycles.com](mailto:warranty@salsacycles.com)

### SALSA CYCLES

6400 West 105th Street, Bloomington, MN 55438

Tel: 877-MOTO-ACE Fax: 952-983-6210

[www.salsacycles.com](http://www.salsacycles.com)